

STF 精密定位型扭力限制器 / Accuracy Positioning Type

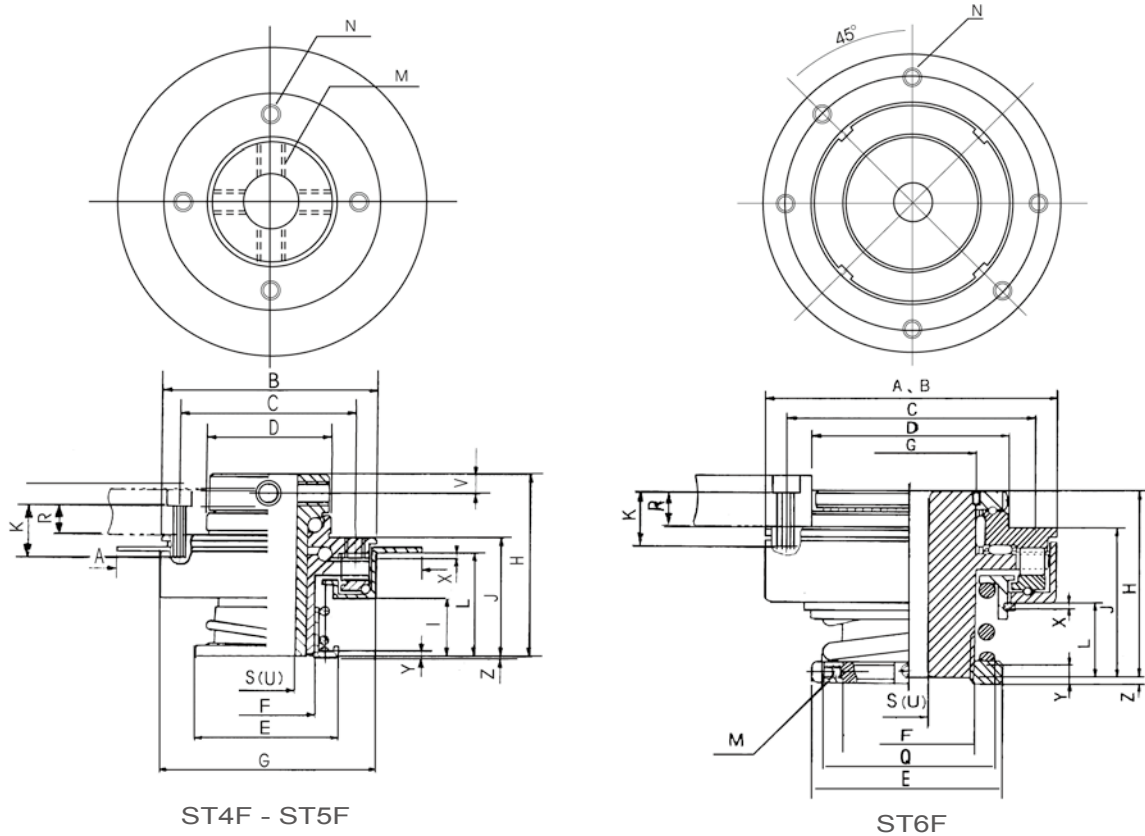

ST4F - ST5F

ST6F

◆尺寸 / Dimension

尺寸單位：mm

規格 No.	扭力 T kg.m	A	B	C	D	E	F	G	H	I	J	K*	L	M	N	Q	孔徑範圍		V	X	(Z)
																	S	U			
ST4F-007C	0.03~0.07	64	46	PCD 36	26 h7	32	M20 P1	46	38	11.2	25	R+4.5	21.2	4-M5 P0.8	4-M4 P0.7 深4.7		7	12	4	1.1	0.7
ST4F-010C	0.04~0.10																				
ST4F-030C	0.1~0.30																				
ST4F-045C	0.15~0.45																				
ST5F-030C	0.08~0.30	82	63	PCD 50	35 h7	45	M30 P1.5	63	50	17.5	34	R+5.5	29.0	4-M6 P1	4-M4 P0.7 深5.7		8	20	6	0.9	1.3
ST5F-060C	0.15~0.60																				
ST5F-100C	0.20~1.00																				
ST5F-180C	0.40~1.80																				
ST6F-07C	0.2~0.7	88	88	PCD 75	60 h7	58	M40 P1.5	M40 P1.5	60			R+7	25.0	2-M5 P0.8	6-M6 P1 深7		15	27		1.3	3.9
ST6F-1C	0.3~1.0																				
ST6F-3C	1.0~3.0																				
ST6F-5C	1.5~5.0																				
ST7F-7A	2.2~7	128	113	PCD 95	75 h7	88	55	M52 P1.5	70			R+9	30.0	2-M5 P0.8	6-M6 P1 深9	102	20	35		1.6	1.7
ST7F-12A	4~12																				
ST7F-25B	8~25																				
ST7F-40B	12~40																				
ST8F-12A	5~12	164	138	PCD 120	100 h7	109	75	M72 P1.5	82			R+11	37.5	2-M5 P0.8	6-M8 P1.25 深11	130	20	48		1.6	0
ST8F-20A	7~20																				
ST8F-40B	12~40																				
ST8F-60B	20~60																				
ST11F-25A	8~25	198	170	PCD 148	120 h7	134	96	M90 P1.5	95			R+13	42.0	2-M5 P0.8	6-M10 P1.5 深13	160	28	62		2.0	2.0
ST11F-35A	12~35																				
ST11F-85B	22~85																				
ST11F-120B	35~120																				
ST14F-30A	11~30	236	206	PCD 180	150 h7	158	120	M120 P1.5	105			R+15	43.5	2-M5 P0.8	6-M12 P1.75 深15	186	30	90		2.6	3.8
ST14F-45A	15~45																				
ST14F-120B	42~120																				
ST14F-180B	60~180																				
ST18F-130A	40~130	280	252	PCD 215	180 h7	220	165	M140 P2	135			R+17	59.0	2-M5 P0.8	6-M16 P2 深20	236	50	110		3.3	5.0
ST18F-180A	80~180																				
ST18F-300B	150~300																				
ST18F-500B	300~500																				

註 *：安裝時特別注意螺絲長度。 Please watch the length of the screw.

STF 精密定位型扭力限制器 / Accuracy Positioning Type

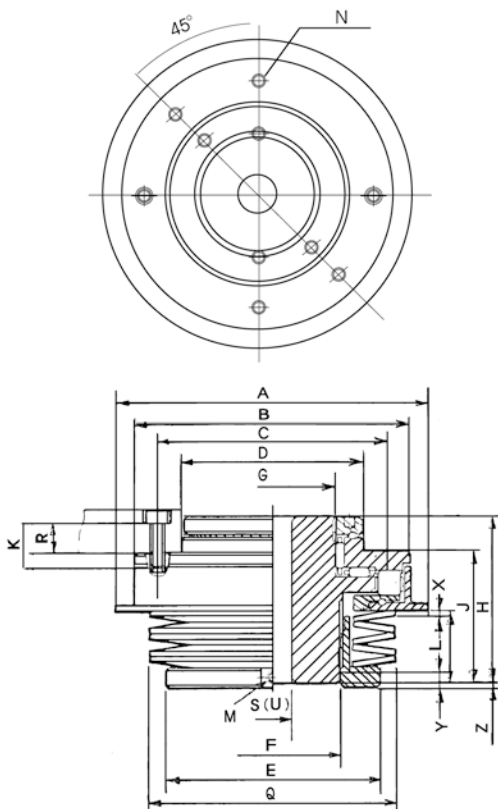

ST7F - ST18F

◆注意事項 / Note

- T : 使用扭力的調整範圍 / Adjustment Range of Applied Torque
- S : 預鑽孔尺寸 / Bore Size
- U : 最大加工孔徑尺寸 / Max. Machined Bore Size
- Kmax : 固定螺絲最大長度(請配合N值使用)
Max. Fixing Screw Length (in compliance with N value)
- X : 過負荷作用時，過負荷檢出盤移動距離，請使用近接開關於迴轉驅動機構上
Moving Range of Overload Detector in the event of overload. The proximity sensor can be applied to the rotation mechanism.
- Z : 扭力彈簧自由長時，驅動輪端面 and 壓緊螺帽端面的段差尺寸，使用此尺寸，算出設定扭力的基準值
The height between the surface of driving wheel and nut surface when torsion spring is at free length, the gap can be the reference to set torque.
- M : 固定壓緊螺帽的固定螺絲外徑與節距調整後請務必將固定螺絲鎖好
Fixing nut by the outer diameter and pitch of screw for fixing nut, be sure of locking the fixing screw after adjustment.
- Tmax : 最大傳達扭力 / Max. Transmissible Torque
- Ymax : 最大調整量 / Max. Adjustment Range
- P : 壓緊螺帽的螺紋節距 / Thread pitch for locking nut
- a : 最大容許軸向推力 / Allowable Max. Axial Thrust
- b : 最大容許側向推力 / Allowable Max. Later Thrust
- c : 最大容許彎曲力距 / Allowable Max. Twisting Torque
- Nmax : 最大容許回轉數 / Allowable Max. Rotational Frequency
- GD : 扭力限制器的慣性距 / Moment of Inertia of Torque Limiter

◆特性表 / Specification

規格 No.	Tmax kg.m	Ymax mm	p mm	a kgf	b kgf	c kgf.m	Nmax rpm	GD ² kgf.m ²	W (kg)
ST4F-007C	0.07	3.3	1	7	40	0.35	2000	2.1×10 ⁻⁴	0.24
ST4F-010C	0.10	3.2							
ST4F-030C	0.30	3.3							
ST4F-045C	0.45	3.5							
ST5F-030C	0.30	4.3	1.5	11	58	0.70	1600	9.4×10 ⁻⁴	0.50
ST5F-060C	0.60	5.0							
ST5F-100C	1.00	6.8							
ST5F-180C	1.80	7.9							
ST6F-07C	0.7	12.0	1.5	390	810	12	800	5.2×10 ⁻³	1.5
ST6F-1C	1	11.0							
ST6F-3C	3	12.0							
ST6F-5C	5	11.0							
ST7F-7A	7	8.5	2	730	1100	20	600	1.9×10 ⁻²	3.4
ST7F-12A	12	8.0							
ST7F-25B	25	8.5							
ST7F-40B	40	7.5							
ST8F-12A	12	8.5	2	1050	1500	38	400	6.0×10 ⁻²	6.2
ST8F-20A	20	7.5							
ST8F-40B	40	8.0							
ST8F-60B	60	7.0							
ST11F-25A	25	13.0	2	1500	2250	68	300	0.14	11.4
ST11F-35A	35	12.0							
ST11F-85B	85	8.5							
ST11F-120B	120	7.5							
ST14F-30A	30	14.0	2	2400	2900	104	250	0.34	20
ST14F-45A	45	12.5							
ST14F-120B	120	13.0							
ST14F-180B	180	11.5							
ST18F-130A	130	13.0	2	3080	3600	147	180	1.2	42
ST18F-180A	180	11.5							
ST18F-300B	300	15.0							
ST18F-500B	500	13.5							