

STC 精密定位型扭力限制器 / Accuracy Positioning Type

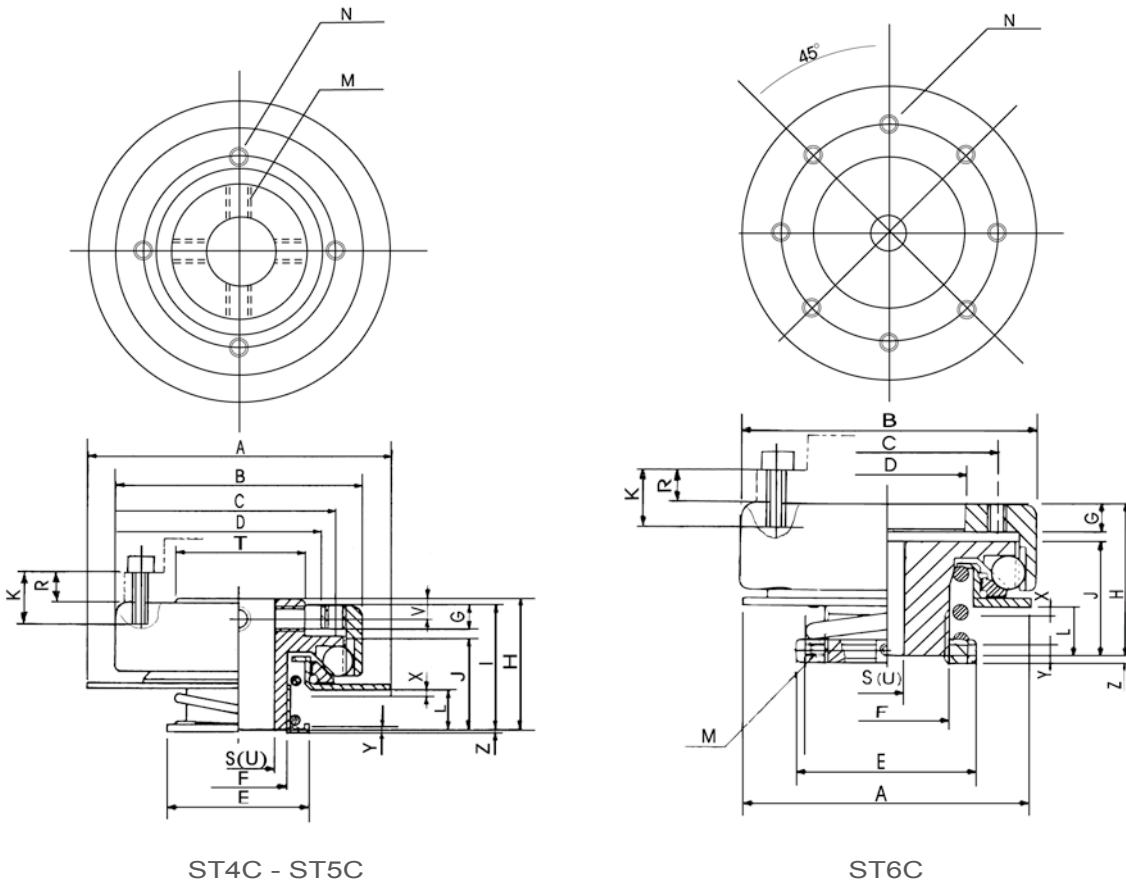

ST4C - ST5C

ST6C

◆尺寸 / Dimension

尺寸單位：mm

規格 No.	扭力 T kg.m	A	B	C	D	E	F	G	H	I	J	K	L	M	N	Q	孔徑範圍		V	T	X	(Z)
																	S	U				
ST4C-007C	0.03~0.07												7.6		4-M4						0.7	0.6
ST4C-010C	0.04~0.10	64	52	PCD	34	32	M20	5	28	27	20.5	R+5	8.0	4.M5	P0.7	7	15	4.5	27	1.1	0.2	
ST4C-030C	0.1~0.30			40	H7		P1						7.6	P0.8	深4.7					0.7	0.6	
ST4C-045C	0.15~0.45												8.0							1.1	0.2	
ST5C-030C	0.08~0.30												13.1		4-M4					0.6	0.3	
ST5C-060C	0.15~0.60	82	71	PCD	46	45	M30	7	40	39	30	R+7	13.7	4.M6	P0.7	8	22	5.5	36	1.2	-0.3	
ST5C-100C	0.20~1.00			55	H7		P1.5						13.1	P1	深5.7				0.6	0.3		
ST5C-180C	0.40~1.80												13.7						1.2	-0.3		
ST6C-06C	0.2~0.6												18.5		8-M6					1.4	3.2	
ST6C-1C	0.3~1.0	93	95	PCD	50	58	M40	9	52		40	R+8	19.0	2.M5	P1	15	27			2.2	2.8	
ST6C-3C	1.0~3.0			70	H7		P1.5						18.5	P0.8	深9				1.4	3.2		
ST6C-5C	1.5~5.0												19.0						2.2	2.8		
ST7C-6A	2~6												30.0		8-M8					1.6	2.0	
ST7C-10A	3~10	128	116	PCD	70	88	55	10	65		52	R+9	31.0	2.M5	P1.25	102	20	35		2.6	0.9	
ST7C-20B	6~20			90	H7								30.0	P0.8	深10				1.6	1.7		
ST7C-35B	10~35												31.0						2.6	0.6		
ST8C-12A	4~12												35.0		8-M8					1.7	2.5	
ST8C-15A	6~12	164	142	PCD	90	108	75	12	75		60	R+11	36.0	2.M5	P1.25	130	20	51		2.7	1.6	
ST8C-35B	10~35			110	H7								35.0	P0.8	深12				1.7	1.8		
ST8C-45B	12~45												36.0						2.7	0.9		
ST11C-20A	7~20												41.5		8-M10					2.0	2.4	
ST11C-35A	10~35	198	176	PCD	110	134	96	16	90		70	R+15	43.0	2.M5	P1.5	160	28	65		3.2	1.0	
ST11C-65B	20~65			130	H7								41.5	P0.8	深16				2.0	0		
ST11C-100B	30~100												43.0						3.2	-1.5		
ST14C-30A	10~30												44.0		8-M12					2.7	4.5	
ST14C-45A	15~45	236	208	PCD	130	158	120	16	100		80	R+15	44.0	2.M5	P1.75	186	30	90		4.3	4.5	
ST14C-130B	50~130			160	H7								44.0	P0.8	深16				2.7	3.5		
ST14C-200B	80~200												44.0						4.3	3.5		
ST18C-160A	70~160												59.0		8-M16					3.7	4.8	
ST18C-250A	100~250	285	285	PCD	170	220	170	18	130		108	R+17	59.0	2.M5	P2	236	50	130		6.2	5.0	
ST18C-380B	160~380			220	H7								59.0	P0.8	深18				3.7	5.0		
ST18C-500B	300~500												59.0						6.2	5.2		

STC 精密定位型扭力限制器 / Accuracy Positioning Type

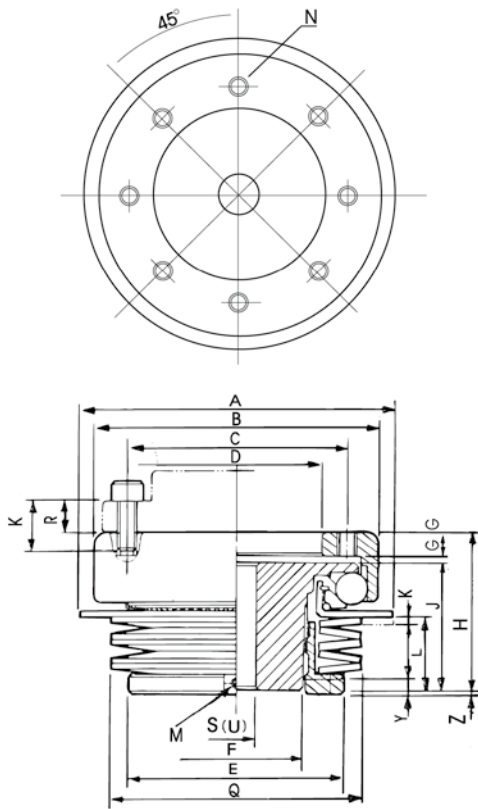

ST7C -ST18C

◆注意事項 / Note

- T: 使用扭力的調整範圍 / Adjustment Range of Applied Torque
 - S: 預鑽孔尺寸 / Bore Size
 - U: 最大加工孔徑尺寸 / Max. Machined Bore Size
 - Kmax: 固定螺絲最大長度(請配合N值使用)
Max. Fixing Screw Length (in compliance with N value)
 - X: 過負荷作用時，過負荷檢出盤移動距離，請使用近接開關於迴轉驅動機構上
Moving Range of Overload Detector in the event of overload. The proximity sensor can be applied to the rotation mechanism.
 - Z: 扭力彈簧自由長時，驅動輪端面和壓緊螺帽端面的段差尺寸，使用此尺寸，算出設定扭力的基準值
The hight between the surface of driving wheel and nut surface when torsion spring is at free length. The gap can be the reference to set torque.
 - M: 固定壓緊螺帽的固定螺絲外徑與節距調整後請務必將固定螺絲鎖好
Fixig nut by the outer diameter and pitch of screw, be sure of locking the fixing screw after adjustment.
 - Tmax: 最大傳達扭力 / Max. Transmissible Torque
 - Ymax: 最大調整量 / Max. Adjustment Range
 - P: 壓緊螺帽的螺紋節距 / Thread pitch for locking nut
 - θ : 偏角誤差的最大吸收量 / Max. Accommodation of Angularity Error
 - α : 隙縫誤差的最大吸收量 / Max. Accommodation of Clearance Error
 - Nmax: 最大容許回轉數 / Allowable Max. Rotational Frequency
 - GD: 扭力限制器的慣性距 / Moment of Inertia of Torque Limiter
- 註(1) / Note 1:
隙縫誤差 α 的值是以組立尺寸H為基準的軸方向移動容許時請務必留意尺寸H
Clearance Error α is based on axial movement of Assembly Size H, be cautious of Assembly Size H
- 註(2) / Note 2:
平行誤差 β 的值是扭力限制器的扭力傳達用滾珠的位置最大吸收量
Parallel Error β is the maximum accommodation of transmissible ball in torque limiter.
- 註(3) / Note 3:
使用回轉數超過Nmax時，請先與敝公司洽談
Please contact with us when the applied rotational frequency is greater than Nmax.

◆特性表 / Specification

規格 No.	Tmax kg.m	Ymax mm	p mm	θ deg	α mm	β mm	Nmax rpm	GD ² kgf.m ²	W (kg)
ST4C-007C	0.07	4.0							
ST4C-010C	0.10	2.7	1	1	± 1.0	0.05	2000	3.6×10^{-4}	0.25
ST4C-030C	0.30	4.0							
ST4C-045C	0.45	3.3							
ST5C-030C	0.30	4.2							
ST5C-060C	0.60	5.9	1.5	1	± 1.0	0.05	1600	1.6×10^{-4}	0.68
ST5C-100C	1.00	6.8							
ST5C-180C	1.80	7.5							
ST6C-06C	0.6	11.0							
ST6C-1C	1	11.0	1.5	1.5	± 1.5	0.05	1000	6.7×10^{-3}	1.5
ST6C-3C	3	11.0							
ST6C-5C	5	11.0							
ST7C-6A	6	9.0							
ST7C-10A	10	8.0	2	1.2	± 1.8	0.1	700	2.3×10^{-2}	3.2
ST7C-20B	20	9.0							
ST7C-35B	35	7.5							
ST8C-12A	12	11.0							
ST8C-15A	15	10.0	2	1.2	± 2	0.1	500	5.5×10^{-2}	5.3
ST8C-35B	35	10.5							
ST8C-45B	45	9.5							
ST11C-20A	20	13.5							
ST11C-35A	35	12.0	2	1	± 2.5	0.1	400	0.14	10.8
ST11C-65B	85	9.0							
ST11C-100B	100	7.5							
ST14C-30A	30	12.0							
ST14C-45A	45	12.0	2	0.7	± 3.5	0.1	300	0.37	20
ST14C-130B	130	13.5							
ST14C-200B	200	13.5							
ST18C-160A	160	16.0							
ST18C-250A	250	16.0	3	0.5	± 3.5	0.1	200	1.6	45
ST18C-380B	380	15.0							
ST18C-500B	500	15.0							